

Harris–Stowe State University
Dr. Henry Givens Jr Administration Building

MAIN AUDITORIUM STAGE IS :

45 Ft. & 4" FROM POST-TO-POST [FRONT WALL BETWEEN FLAG POLES]*

40 Ft. ACROSS [STAGE FLOOR W/CURVE]

20 Ft. DEEP [LENGTH FRONT TO BACK]

35 Ft. ACROSS [BACK]

SIGNS: CAN BE AS LARGE AS 7Ft. x 6Ft.

MAIN AUDITORIUM DIMENSIONS:

1. HEIGHT: 45 FT.

2. LENGTH: 74 FT. 9 IN.

3. WIDTH: 80 FT 6 IN.

4. DEPTH: 3 FT 9 ½ IN

BALCONY DIMENSIONS:

1. LENGTH: 32 FT. 7 IN.

2. WIDTH: 81 FT. 5 IN.

3. DEPTH: 13 FT. 3 IN.

REVISED: 10/13

STAGE



49
48
47
46
45
44

1
2
3
4
5
6
7

ROW	43	42	41	40	39	38	37	36	35	34	33	32	ROW
A													A
B	41	40	39	38	37	36	35	34	33	32	31	30	B
C	41	40	39	38	37	36	35	34	33	32	31	30	C
D	41	40	39	38	37	36	35	34	33	32	31	30	D
E	41	40	39	38	37	36	35	34	33	32	31	30	E

ROW	31	30	29	28	27	26	25	24	23	22	21	20	ROW
A													A
B	27	26	25	24	23	22	21	20	19	18	17	16	B
C	27	26	25	24	23	22	21	20	19	18	17	16	C
D	27	26	25	24	23	22	21	20	19	18	17	16	D
E	27	26	25	24	23	22	21	20	19	18	17	16	E

ROW	19	18	17	16	15	14	13	12	11	10	9	8	ROW
A													A
B	14	13	12	11	10	9	8	7	6	5	4	3	B
C	14	13	12	11	10	9	8	7	6	5	4	3	C
D	14	13	12	11	10	9	8	7	6	5	4	3	D
E	14	13	12	11	10	9	8	7	6	5	4	3	E

ROW	36	35	34	33	32	31	30	29	28	27	26	25	ROW
F													F
G	36	35	34	33	32	31	30	29	28	27	26	25	G
H	36	35	34	33	32	31	30	29	28	27	26	25	H

ROW	24	23	22	21	20	19	ROW
F							F
G	24	23	22	21	20	19	G
H	24	23	22	21	20	19	H

18	17	16	15	14	13	ROW
18	17	16	15	14	13	F
18	17	16	15	14	13	G
18	17	16	15	14	13	H

ROW	12	11	10	9	8	7	6	5	4	3	2	1	ROW
F													F
G	12	11	10	9	8	7	6	5	4	3	2	1	G
H	12	11	10	9	8	7	6	5	4	3	2	1	H

LEFT

CENTER

RIGHT

CENTER ENTRANCE

Main Auditorium Balcony

Harris-Stowe State University
Emerson Performance Center and Bank of America Theater

Bank of America Theater:

Stage Measurements: 39ft. (Post-to-Post)
Stage Floor Length: 42 ft.
Stage Floor Depth: 34 ft.
Back of Stage Floor: 64 ft.

Theater Dimensions Length: 38 ft.
Theater Dimensions Width: 54 ft.
Theater Balcony Dimensions: 18 ft in Length:
Theater Balcony Dimensions: 54 ft in Width:

The Bank of America Theatre rows and seats are as follows:

Row	Section 1 Seats	Section 2 Seats	Section 3 Seats
J	1 through	22	23-28
I	1-7	8-20	21-26
H	1-7	8-20	21-26
G	1-6	7-19	20-25
F	1-5	6-18	19-24
E	1-3	4-13	14-17
	Entryway Aisle		To foyer →
D	1-6	7-14	15-18
C	1-5	6-17	18-24
B	1-4	5-16	17-23
A (Nearest the stage)	1-3	4-15	16-21

S T A G E

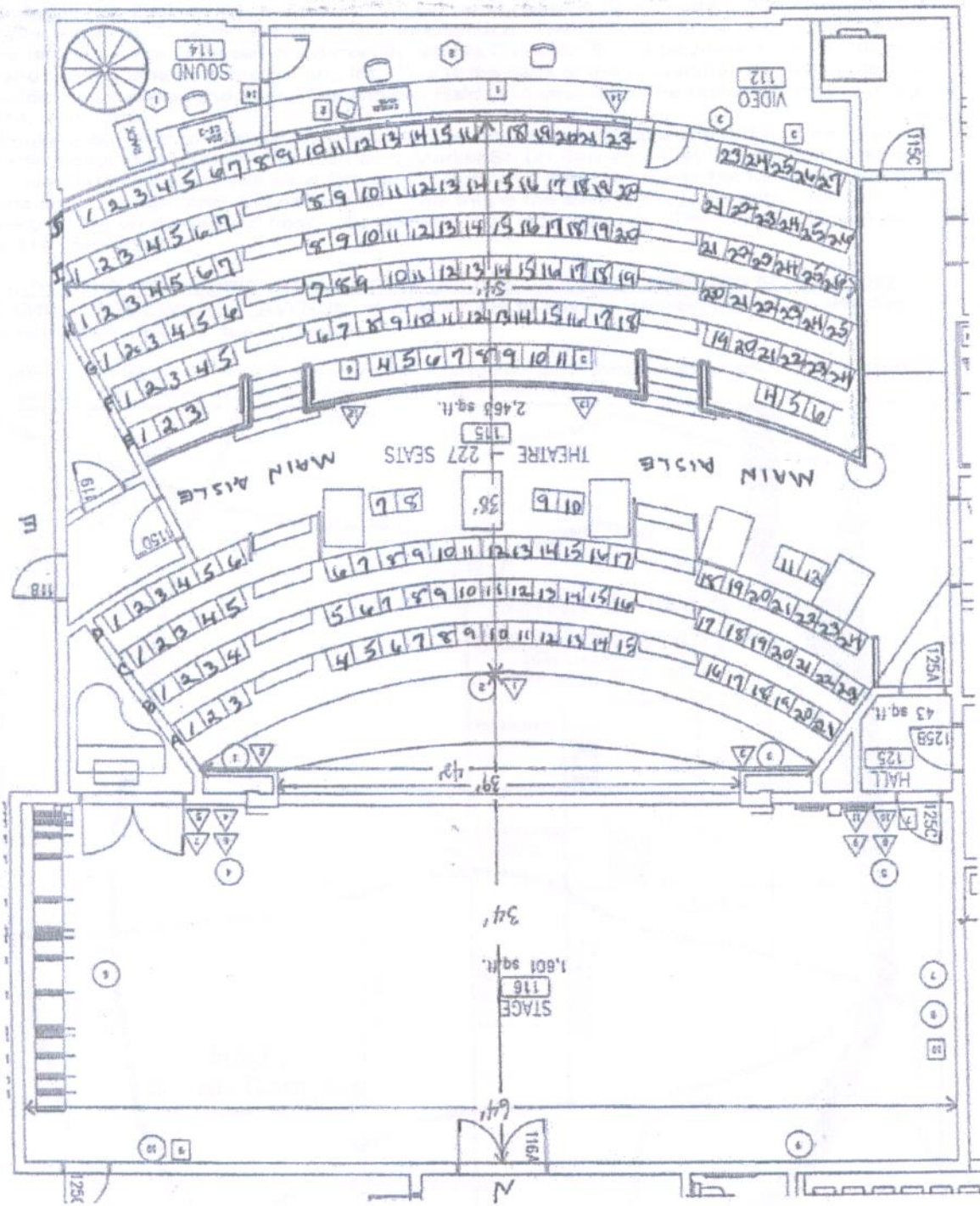

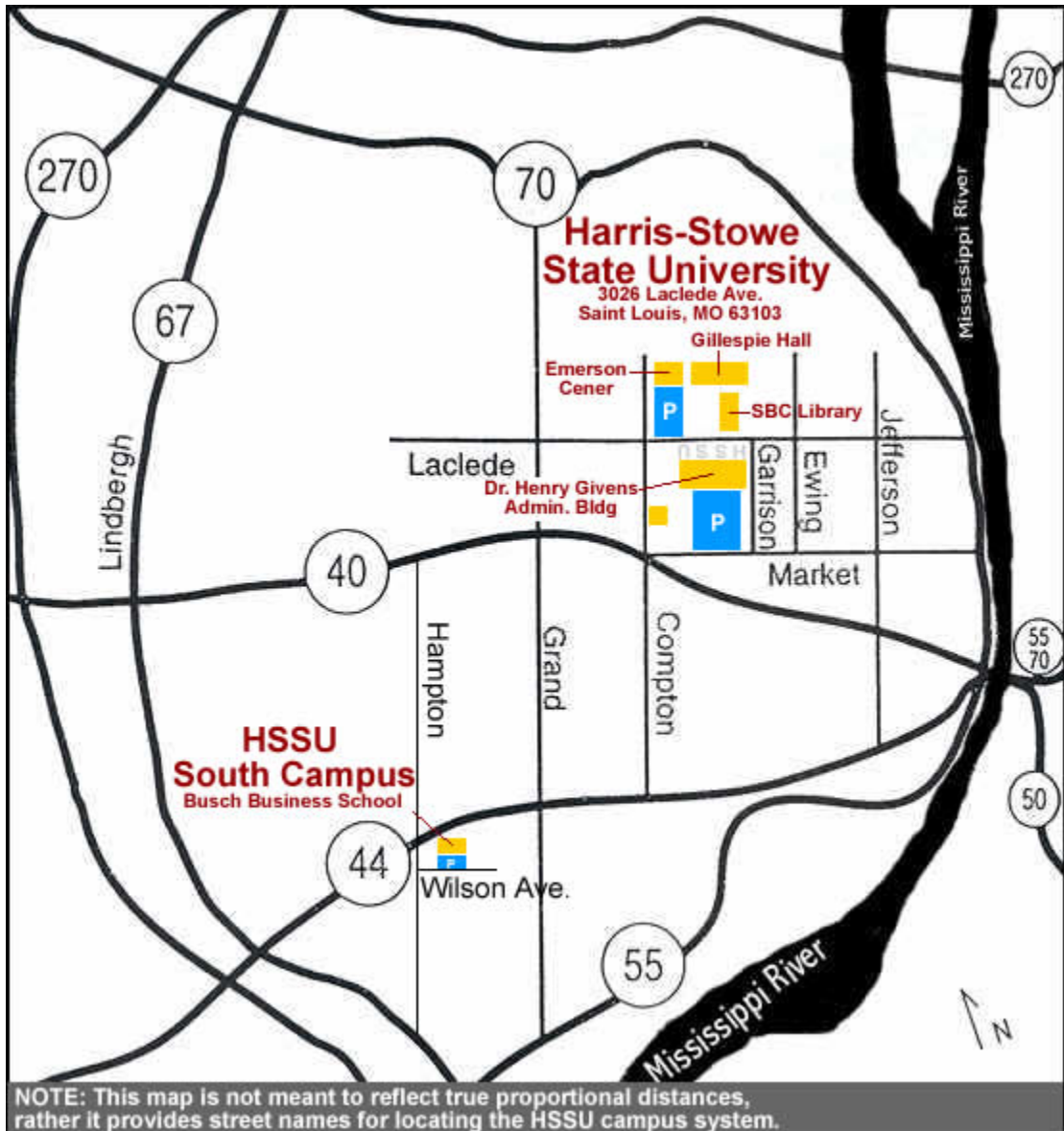

DIRECTIONS HARRIS-STOWE STATE UNIVERSITY:

Highway 40 East to Harris-Stowe State University Market Street exit#37A and travel to the traffic signal at Compton & Market Sts. Intersection. Harris-Stowe State University is visible on the left hand side. Proceed on Market St. across Compton St. traffic signal & drive into the left hand turning lane onto the parking lot. This is the back of the University. You will enter the building on the ground floor. The Athletic Field is to your left. The University main number is 314. 340.3366.

Highway 40 West to Harris-Stowe State University Market Street exit #38B and travel to the traffic signal at Market St. Turn left onto Market St. (at Garrison Ave) Intersection. Harris-Stowe State University will be visible on the right and side. Drive into the far right hand turning lane and turn right onto the parking lot. This is the back of the University. You will enter the building on the ground floor. The Athletic Field is to your left. The University main number is 314. 340. 3366.

DIRECTIONS TO HARRIS-STOWE STATE UNIVERSITY BUSCH BUSINESS SCHOOL – SOUTH CAMPUS, 5707 WILSON AVENUE : From HSSU Main Campus - HIGHWAY I-64 to 40-W to Hampton Exit, turn left, next street Wilson Avenue, turn left again

Back to HSSU Main Campus : Turn right off of Wilson, stay in right lane to Highway I-44, to on ramp to Grand Avenue @ Lafayette exit ramp; turning left to exit onto Grand Avenue to Lafayette, turn right onto Lafayette keep driving until drive to Compton Avenue; turn left onto Compton Avenue, keep driving past Park Ave, keep driving Past Chouteau Avenue straight onto the bridge overpass at Market Street Intersection, HSSU visible directly in front of you on your right; turn right onto Market Street to left lane and turn into parking lot, you are on HSSU Main Campus, back of building - - -